

PIAZZA, 12' DEEP

LORDS OF THE COUNCIL
BOXES

7 ROWS OF 2' SEATS
"WILL CONTEYNE 200
PERSONS TO SIT AT EASE."

ACCESS PASSAGE 2.5'

13 ROWS OF SEATS,
18" WIDE
FOR 350 PERSONS

PASSAGE UNDER
SEATS

RAILS FOR 130
LOOKING UNDER

LIGHTS AND SEATS FOR
LADIES AND SERVANTS

STAIRS FROM LOBBY

SCAFFOLDS FOR 130

25 Author's reconstruction of Christ Church Hall, Oxford
(40' x 115'), arranged for a royal performance, probably by
Inigo Jones, August 27, 1605

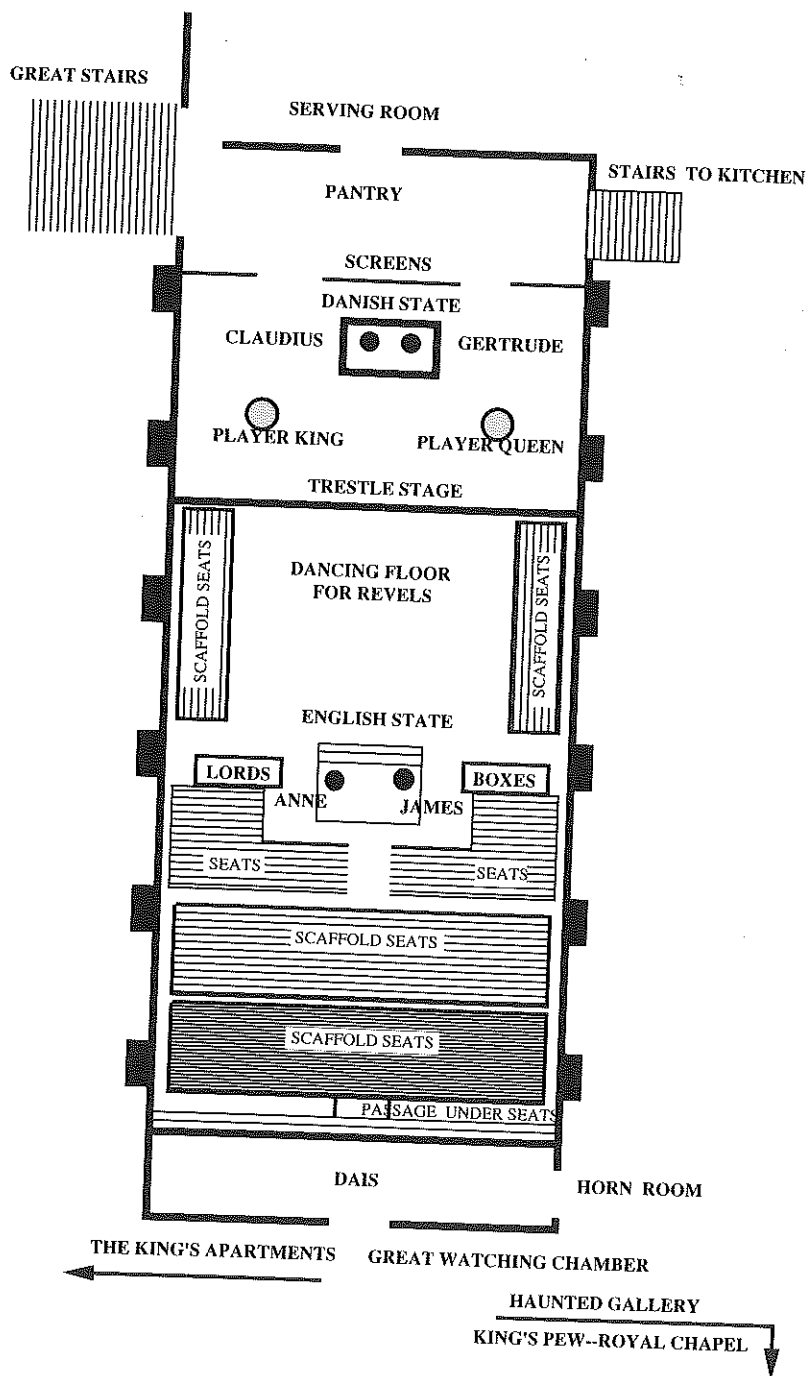

23 Author's reconstruction of the Great Hall, Hampton Court, set up at Christmas 1603; play within the play, *Hamlet*, 3.2

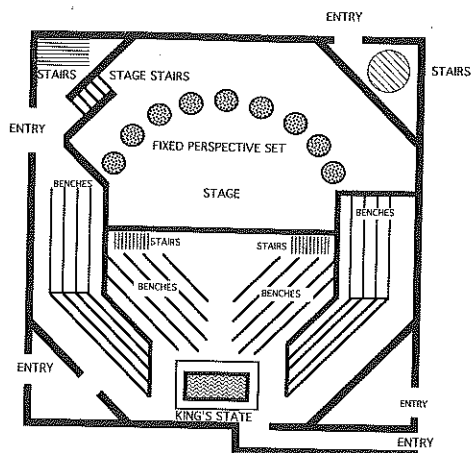

27 Author's reconstruction of the
Cockpit in the Court, Whitehall,
Jones and Webb, 1635

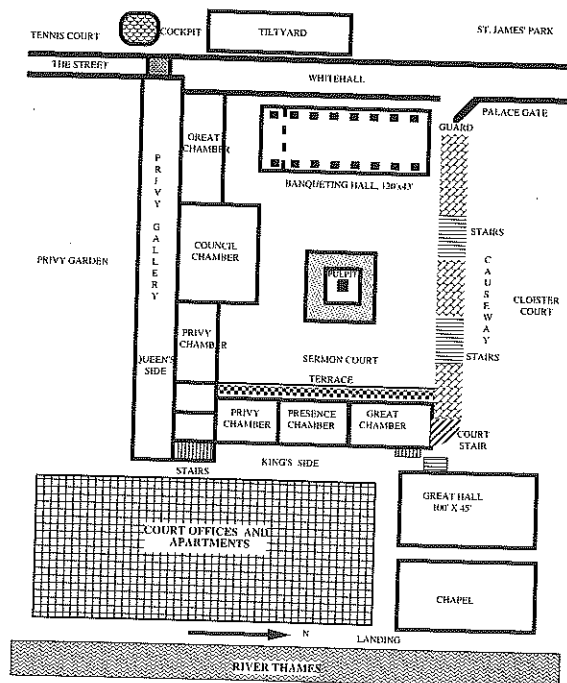

28 Author's reconstruction of the
ground plan of Whitehall